

SERVICE REPAIR

MANUAL

Hyster B479 (C80ZAC) Forklift Service Repair
Manual

HYSTER

PERIODIC MAINTENANCE

T5Z^{AC} [B476]; T7Z^{AC} [B477];
C60Z^{AC} [B478]; C80Z^{AC} [B479]

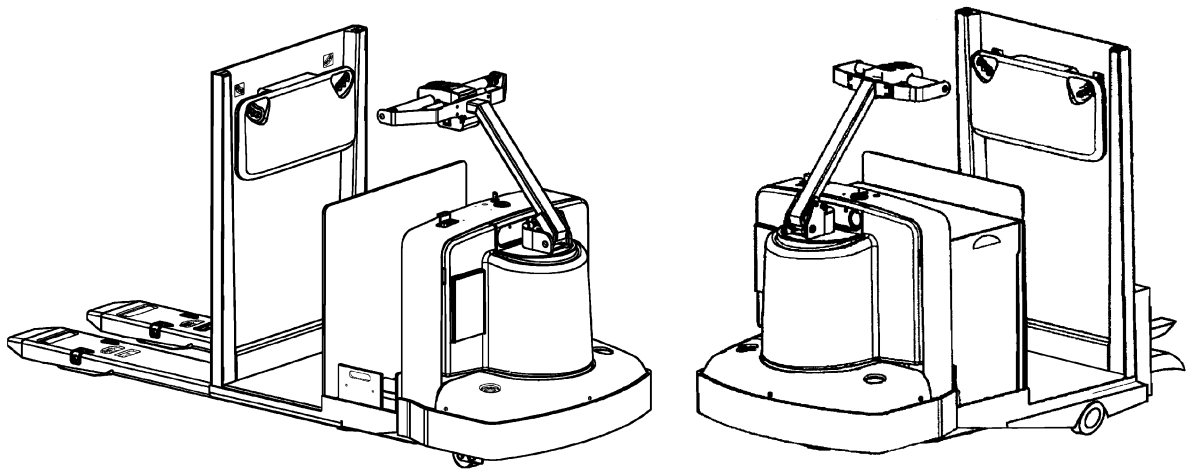

HYSTER

SAFETY PRECAUTIONS

MAINTENANCE AND REPAIR

- When lifting parts or assemblies, make sure all slings, chains, or cables are correctly fastened, and that the load being lifted is balanced. Make sure the crane, cables, and chains have the capacity to support the weight of the load.
- Do not lift heavy parts by hand, use a lifting mechanism.
- Wear safety glasses.
- DISCONNECT THE BATTERY CONNECTOR before doing any maintenance or repair on electric lift trucks. Disconnect the battery ground cable on internal combustion lift trucks.
- Always use correct blocks to prevent the unit from rolling or falling. See HOW TO PUT THE LIFT TRUCK ON BLOCKS in the **Operating Manual** or the **Periodic Maintenance** section.
- Keep the unit clean and the working area clean and orderly.
- Use the correct tools for the job.
- Keep the tools clean and in good condition.
- Always use **HYSTER APPROVED** parts when making repairs. Replacement parts must meet or exceed the specifications of the original equipment manufacturer.
- Make sure all nuts, bolts, snap rings, and other fastening devices are removed before using force to remove parts.
- Always fasten a DO NOT OPERATE tag to the controls of the unit when making repairs, or if the unit needs repairs.
- Be sure to follow the **WARNING** and **CAUTION** notes in the instructions.
- Gasoline, Liquid Petroleum Gas (LPG), Compressed Natural Gas (CNG), and Diesel fuel are flammable. Be sure to follow the necessary safety precautions when handling these fuels and when working on these fuel systems.
- Batteries generate flammable gas when they are being charged. Keep fire and sparks away from the area. Make sure the area is well ventilated.

NOTE: The following symbols and words indicate safety information in this manual:



WARNING

Indicates a condition that can cause immediate death or injury!



CAUTION

Indicates a condition that can cause property damage!

On the lift truck, the WARNING symbol and word are on orange background. The CAUTION symbol and word are on yellow background.

TABLE OF CONTENTS

Introduction.....	1
General.....	1
Drive Unit Compartment Covers.....	3
Remove.....	3
Install.....	3
How to Move a Disabled Truck.....	4
How to Tow the Truck.....	4
How to Put the Truck on Blocks.....	5
How to Raise Drive/Steer Tire.....	5
How to Raise the Load Wheels.....	5
Special Precautions.....	6
Maintenance Schedule.....	7
Maintenance Procedures Every 8 Hours or Daily.....	11
Checks With the Key Switch OFF.....	11
Safety Labels.....	11
Battery.....	12
Frame.....	12
Drive Tire, Casters (Optional), and Trail Wheels or Load Wheels.....	13
Lift Linkage (C60-80Z ^{AC}).....	13
Coupler (T5-7Z ^{AC}).....	13
Steering Operation.....	13
Checks With the Key Switch ON.....	13
Control Handle.....	13
Gauges.....	14
Fuses.....	14
High Speed Switch.....	14
Hydraulic (C60-80Z ^{AC}).....	14
Hand Brake.....	15
Maintenance Procedures Every 250 Hours or Every 6 Weeks.....	15
Caster Lubrication.....	15
Maintenance Procedures Every 500 Hours or Every 3 Months.....	16
Hydraulic System.....	16
Hydraulic Oil.....	17
Hydraulic Reservoir Breather.....	17
Steering System.....	17
Steer Column and Tilt Mechanism.....	17
Lift Linkage and Load Wheels (C60-80Z ^{AC}).....	17
Casters.....	17
Caster Shim Check.....	17
Caster Shim Adjust.....	18
Master Drive Unit.....	19
Change Gear Oil.....	19
Check Oil Level.....	19
Drive Tire Check.....	20
Maintenance Procedures Every 2000 Hours or Yearly.....	20
Trail Wheel Bearings (T5-7Z ^{AC}).....	20
Remove.....	20
Inspect.....	20
Install.....	21
Hydraulic System (C60-80Z ^{AC}).....	22
Changing the Hydraulic Oil.....	22

**Thanks very much for your reading,
Want to get more information,
Please click here, Then get the complete
manual**

JustClickHere 

NOTE:

**If there is no response to click on the link above,
please download the PDF document first, and then
click on it.**

**Have any questions please write to me:
admin@servicemanualperfect.com**

TABLE OF CONTENTS (Continued)

Master Drive Unit	26
Drive Unit Gear Oil.....	26
Brakes	26
Welding Repairs	27
Battery Maintenance	27
How to Charge Battery.....	27
How to Change Battery	28
Adjusting the Battery Spacers.....	28
Changing Battery With Rollers	28
Remove	29
Install.....	29
Remove Battery Using Overhead Crane.....	29
Install Battery Using Overhead Crane.....	30
Battery Specifications	30

This section is for the following models:

T5Z^{AC} [B476];
T7Z^{AC} [B477];
C60Z^{AC} [B478];
C80Z^{AC} [B479]

Introduction

GENERAL

This section contains the instructions for periodic maintenance and inspection and a Maintenance Schedule.

The Maintenance Schedule has time intervals for inspection, lubrication, and periodic maintenance. The time intervals are based on normal operation. Normal operation is considered to be one 8-hour shift per day in a relatively clean environment on an improved surface. Multiple shifts, dirty operating conditions, etc., will require a reduction in the recommended time periods in the Maintenance Schedule.



WARNING

DO NOT make repairs or adjustments unless you have been properly trained and authorized to do so. Improper repairs and adjustments can create dangerous operating conditions.

DO NOT operate a truck that needs repairs. If repair is necessary, attach a DO NOT OPERATE tag to the control handle. Report the need for repairs to your supervisor immediately.

Some users have service personnel and facilities to perform the procedures listed in the Maintenance Schedule. Service Manuals are available from your Hyster™ lift truck dealer to help users who do their own repairs.

Your Hyster™ lift truck dealer has the trained personnel and equipment to conduct a complete program of inspection, lubrication, and maintenance. This program will help maximize your truck's performance and reliability.

NOTE: The front end of the truck is the control handle end. Forward travel refers to movement in the direction of the control handle with the load wheels trailing. Reverse is travel in the direction of the forks with the drive tire trailing. Left and right refer to the operator's left- and right-hand sides when standing on the truck, driving in the forward direction. See Figure 1.

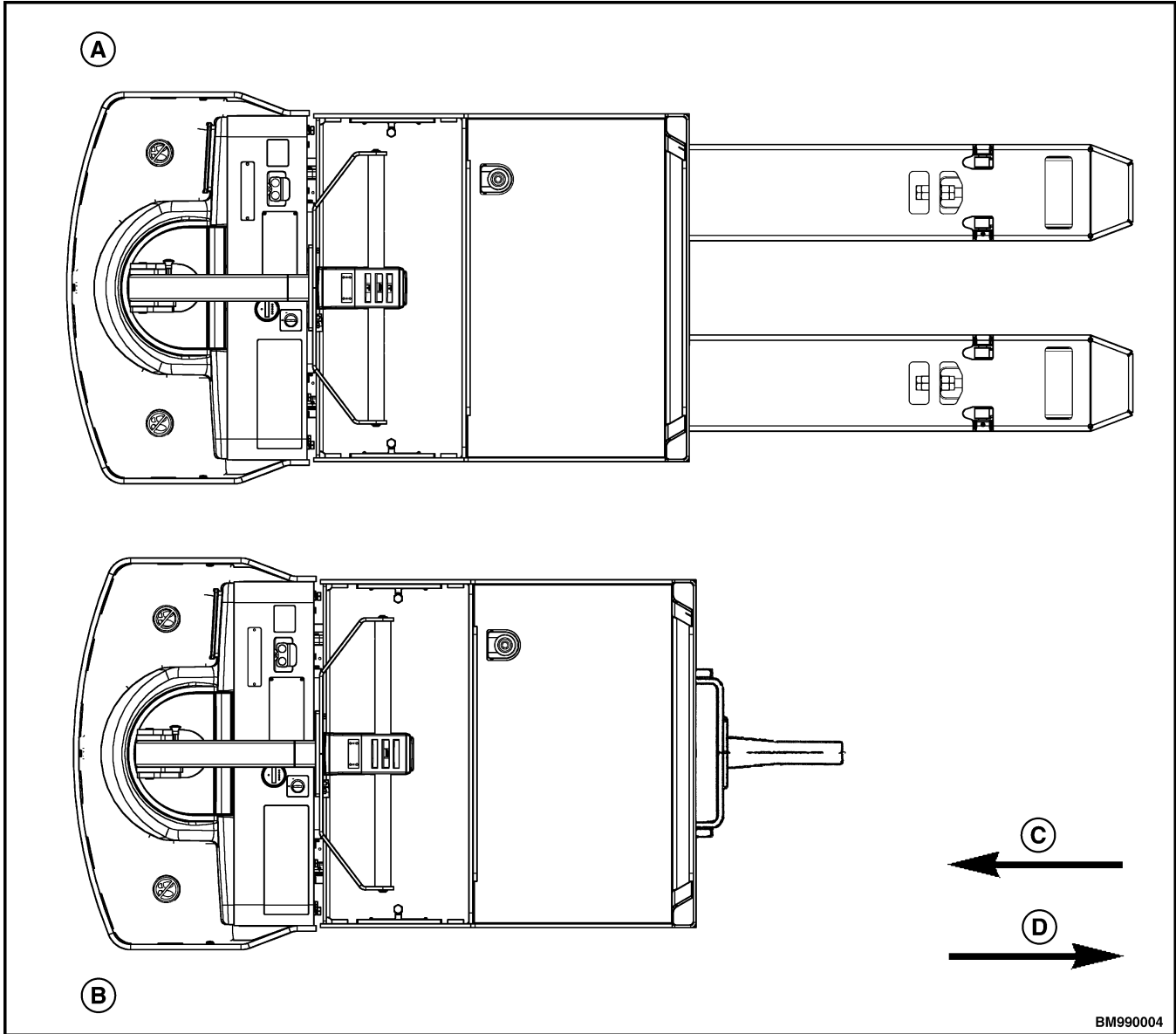

A. RH SIDE
B. LH SIDE

C. FORWARD
D. REVERSE

Figure 1. Truck Orientation

DRIVE UNIT COMPARTMENT COVERS

Many procedures require access to the drive unit compartment. The drive unit compartment is located at the front of the truck in front of the battery and below the control handle assembly. Two covers must be removed to access the drive unit compartment. The covers must be correctly reinstalled to protect the electrical system and other components housed in the drive unit compartment. See Figure 2.

Remove

1. Remove the three screws retaining the lower drive unit compartment cover.
2. Lift the lower cover from the drive unit compartment.

3. Pull the bottom edge on one side of the upper cover from the drive unit compartment. Continue pulling around the edge of the cover until completely removed from the truck.

Install

1. Place the top corners of the upper cover into the retaining clips in the drive unit compartment.
2. Working around each side, bump the cover into place using the heel of the hand or a rubber hammer.
3. Place the lower cover into the bottom of the drive unit compartment.
4. Secure lower cover in place using three screws.

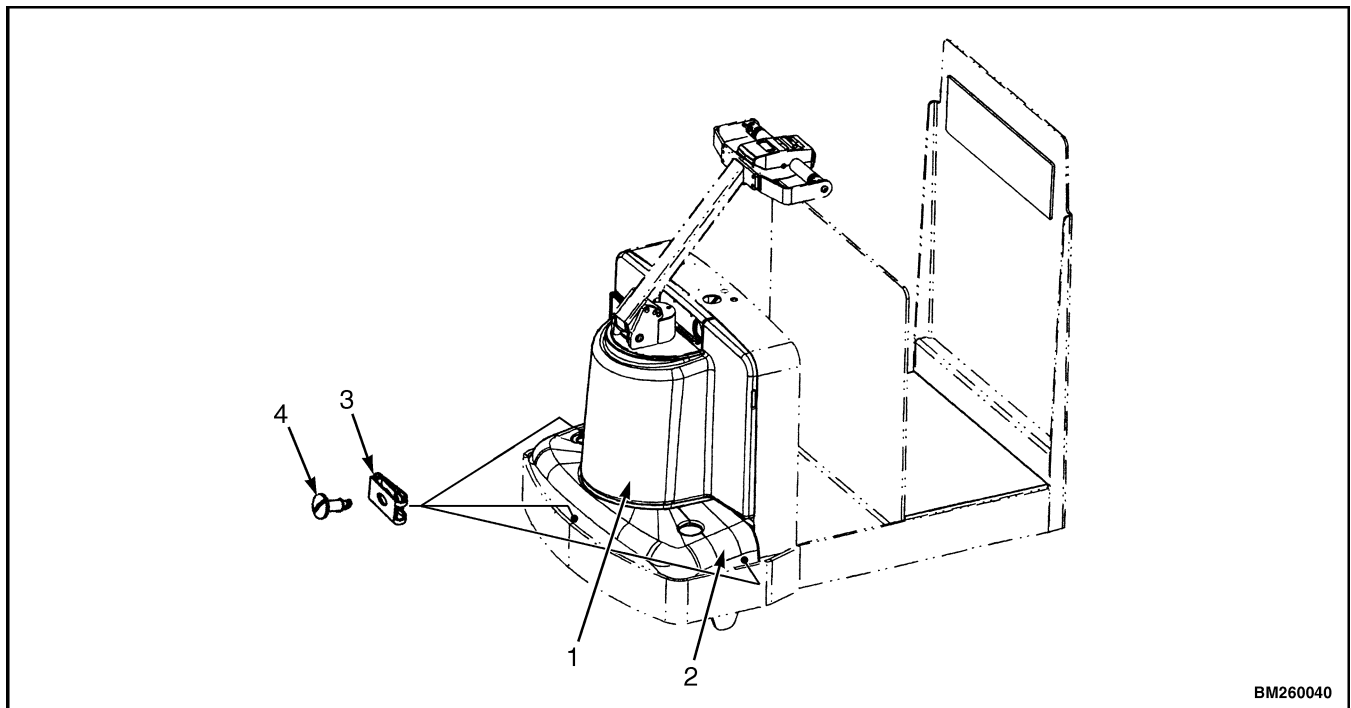

1. FRONT COVER
2. LOWER COVER

3. SPRING NUT CLIPS
4. SCREWS

Figure 2. Drive Unit Compartment Covers

HOW TO MOVE A DISABLED TRUCK

Trucks are not normally towed. If the traction system will not operate, make repairs at the location, if possible. If the truck must be towed, tow the truck forward (in the direction of the control handle).

CAUTION

Never attempt to tow by fastening any towing device to the control handle.

Carefully attach the tow chain completely around the motor compartment and battery compartment. Make sure the tow chain is installed on the truck so the chain will not cause damage. Make sure the parking brake is released on the truck. Steer the truck with the control handle while it is being towed. **DO NOT** get between the towing vehicle and the disabled truck.

How to Tow the Truck

WARNING

Use extra care when moving a truck during the following conditions:

- Brake does not operate correctly
- Steering does not operate correctly
- Tire is damaged
- Traction conditions are bad

If there is no power, the drive wheel will not turn freely. Poor traction can cause the disabled truck or towing vehicle to slide. Grades will require additional distance to stop.

Never carry a disabled truck unless it **MUST** be moved and cannot be towed. The lift truck used to lift the disabled truck **MUST** have a rated capacity equal to or greater than the weight of the truck. See the nameplate on the truck for the approximate total weight. The fork spread must be equal to half the width of the disabled truck. The forks must extend the full width of the disabled truck. Put the weight of the disabled truck at the center of the forks and be careful not to damage the underside of it. Tilt the mast back and travel slowly.

Be sure to stay clear of the tow chain, towing vehicle, and truck during the towing operation to prevent injury.

CAUTION

Never tow the lift truck faster than the speed of a person walking. Steering can be difficult and motor damage can occur at higher speeds. Always tow smoothly without sudden starts. Never tow the lift truck using the control handle. Make sure the brake has been released before towing. Refer to the section Brakes 1800 SRM 1285.

1. Remove the drive unit compartment covers. See Drive Unit Compartment Covers. Fasten the tow chain completely around the motor and battery compartments. Make sure the tow chain has the capacity to tow the weight. The chain must not cause damage to either truck.
2. Connect the battery. Turn the key switch to the **ON** position and the parking brake switch to the **OFF** position.

WARNING

Make sure no one except the driver is near the truck during towing. Both the tow truck and the disabled truck can cause an injury during towing.

CAUTION

Travel slowly and **DO NOT** tow on grades. **NEVER** tow the lift truck faster than a normal walking speed. Always tow smoothly without sudden starts or stops.

The control handle should be marked with a **DO NOT OPERATE** tag until the repairs have been completed.

3. Tow the lift truck slowly while a driver steers the truck while walking along side.

4. If towing with lift truck, add weight to the forks of the lift truck if the drive wheels are near the forks. The total weight of the lift truck and load must be equal to or greater than the weight of the disabled truck. Install a load of approximately half the maximum capacity on the forks of the towing lift truck. This load will increase the traction of the lift truck.

DO NOT add weight to the forks if the lift truck used for towing has a master drive unit (MDU) or drive unit on the opposite end as the forks. Additional weight on the forks may **DECREASE** the traction of the drive wheel. Make sure that the towing truck has a total weight equal to or greater than the weight of the disabled truck. Keep the load on the forks lowered as much as possible.

HOW TO PUT THE TRUCK ON BLOCKS



WARNING

DO NOT put the truck on blocks if the surface is not solid, even, and level. Make sure that any blocks used to support the truck are solid, one-piece units. Put a block in front and back of the tires touching the ground to prevent movement of the lift truck.

DO NOT raise the truck by attaching an overhead lifting device to areas that can be damaged. Some points of the truck are not designed to support the weight of the truck. The truck can be damaged or it can fall, causing serious injury. Attach the chain or sling to a support structure of the lift truck frame.

DO NOT make repairs or adjustments unless specifically authorized to do so. Repairs and adjustments must be performed by trained service technicians.

How to Raise Drive/Steer Tire

1. Put blocks on both the front and back sides of the load wheels to prevent movement of the truck.

Use a special low-clearance hydraulic jack, crane, or a lift truck to raise the drive tire. Make sure that the jack, crane, or lift truck has the correct capacity rating. The capacity must equal at least 2/3 the weight of the truck, including the battery. See the nameplate for truck weight. On the C60-80Z^{AC}, the lifting mechanism may be used to lift the truck and lower it onto blocks.

2. Raise the lift truck enough to suspend the drive tire. Install hardwood blocks under the frame on both sides of the truck.

How to Raise the Load Wheels



WARNING

Never raise the truck any higher than necessary to change the load wheels. Always raise both sides at the same time. Raising either side too high can cause the truck to tip over and cause damage or serious injury.

1. Put blocks on both the front and back sides of the drive tire to prevent movement of the truck.
2. Use an overhead lifting device and web sling under the truck at the rear to raise the load wheels. A lift truck can also be used to raise the rear of the truck. Make sure the overhead lifting device and web sling or lift truck has a capacity of at least 2/3 the total weight of the truck being lifted, including the battery. See the nameplate for the lift truck weight. On the C60-80Z^{AC}, the lifting mechanism may be used to lift the truck and lower onto blocks.
3. Raise the truck enough to suspend the load wheels. Install blocks under the truck to the front of the load wheels to support the truck.

Special Precautions

WARNING

DO NOT make repairs or adjustments unless you have both authorization and training. Repairs and adjustments that are not correct can create dangerous operating conditions. DO NOT operate a lift truck that needs repairs. Report the need for repairs to your supervisor immediately. If repair is necessary, turn the key switch to the OFF position, disconnect the battery, and attach a DO NOT OPERATE tag to the control handle.

Verify that the battery had been disconnected before opening the drive unit compartment cover or inspecting or repairing the electrical system. If a tool causes a short circuit, the high current flow from the battery can cause personal injury or property damage.

Some checks and adjustments are done with the battery connected. DO NOT connect the battery until the procedure tells you to do so. Never wear jewelry or other metallic objects on your fingers, arms, or neck when servicing the lift truck. Metal items can accidentally make an electrical connection and cause injury.

Before performing any tests or adjustments, block the lift truck wheels to prevent unexpected movement.

The capacitor in the transistor controller can hold an electrical charge after the battery has been disconnected. To prevent an electrical shock and personal injury, discharge the capacitor before inspecting or repairing any component in the drive unit compartment. Wear safety glasses. Make certain that the battery has been disconnected.

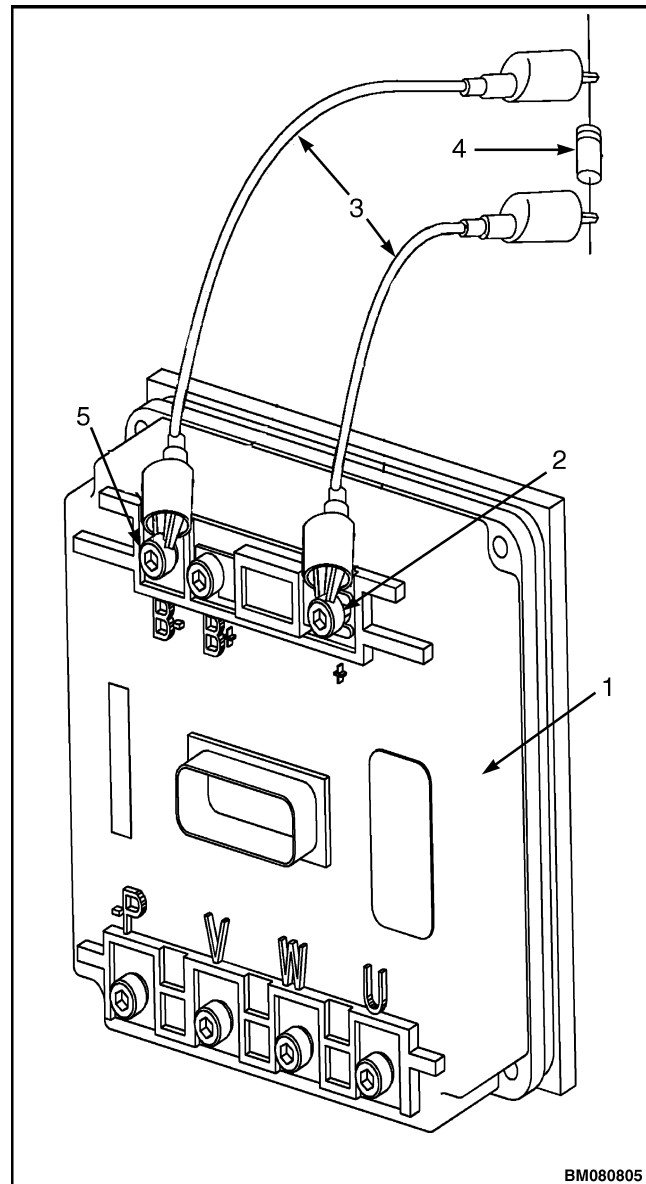

1. CONTROLLER
2. POSITIVE CONNECTION
3. INSULATED JUMPER WIRES
4. 200-OHM, 2-WATT RESISTOR
5. NEGATIVE CONNECTION

*Figure 3. Discharging the Capacitors
(C60-80Z^{AC} and T5-7Z^{AC})*

 **CAUTION**

To avoid controller damage, always disconnect the battery and discharge the capacitor. Never put power to the controller while any power wires are disconnected. Never short any controller terminal or motor terminal to the battery. Make sure to use proper procedure when servicing the controller.

1. Block load wheels to prevent lift truck from moving.

2. Turn the key switch to the **OFF** position and disconnect the battery.
3. Discharge the capacitors in the controllers by connecting a 200-ohm, 2-watt resistor across the controller's B+ and B- terminals. **DO NOT** short across the motor controller terminals with a screwdriver or jumper wire.
4. Remove the 200-ohm, 2-watt resistor before reconnecting the battery. See Figure 3.

Maintenance Schedule

The Maintenance Schedule is divided into four time intervals which call for particular maintenance procedures to be performed. The intervals are 1 Day or 8 Hours, 6 Weeks or 250 Hours, 3 Months or 500 Hours, and 1 Year or 2000 Hours for normal operation (whichever comes first). **Normal** operation is considered one 8-hour shift per day, in a relatively clean environment, on an improved surface. Operating a lift truck for more than eight hours per

day is considered **Heavy** operation and requires the 3-month/500-hour checks to be performed at 2 months/350 hours. Lift trucks operating in freezer environments or dirty conditions are considered **Severe** operation and require the 3-month/500-hour checks to be performed at 1 month/200 hours. The approximate locations of the items listed in the Maintenance Schedule are shown in Figure 4.

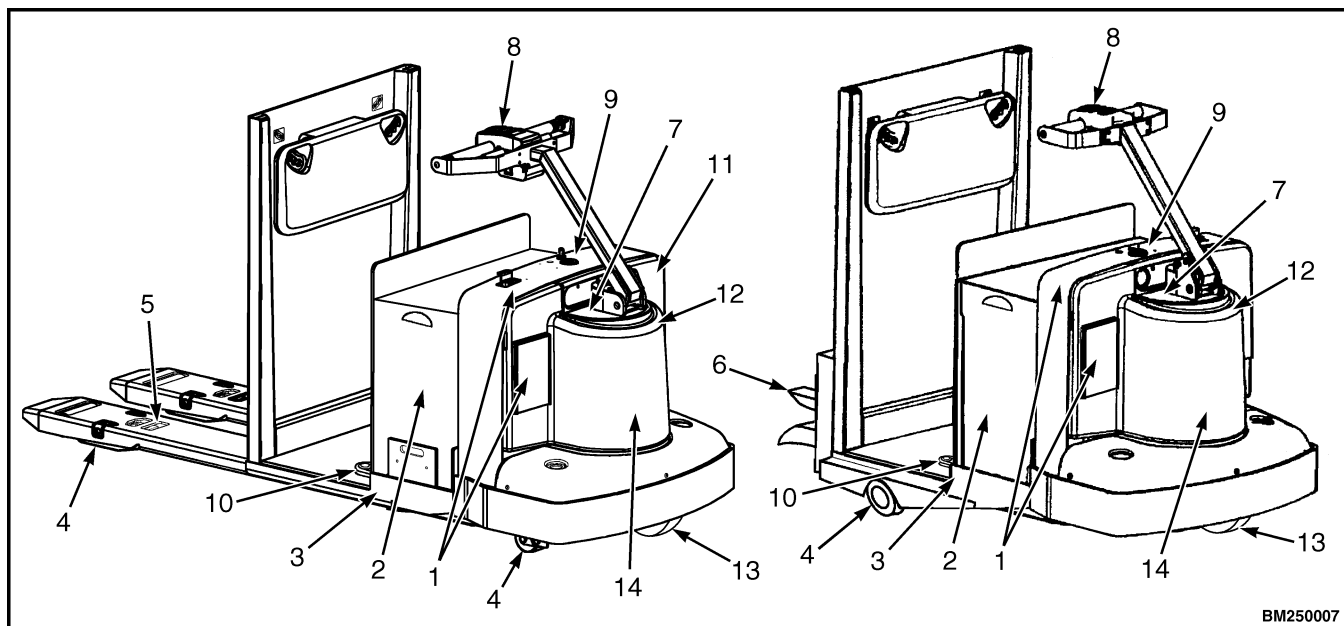

Figure 4. Maintenance Points

Table 1. Maintenance Schedule

Item No.	Item	1 day/ 8 hr	6 wk/ 250 hr	3 mo/ 500 hr	1 yr/ 2000 hr	Procedure or Quantity	Specification
1	Safety Labels and Operating Manual	X				Replace if Missing or Damaged	See Parts Manual
2	Battery	X				Check Charge Status (See NOTE 1)	Charge or Change Out
	Electrolyte	X				Check Level	Distilled Water
	Restraint Panels	X				Check Condition	Repair as Necessary
	Power Disconnect	X				Check Operation	Repair as Necessary
3	Frame	X				Visually Inspect	Repair as Necessary
4	Trail Wheels (T5-7Z ^{AC})	X				Check Condition	Repair or Replace as Necessary
	Bearings				C	Repack Bearings/ Replace As Necessary	Multipurpose Grease (See NOTE 2)
	Wheels	X				Inspect for Damage	Smooth Edges/ Remove Embedded Objects
	Axles				L	Lube	Antiseize Lubricant
4	Load Wheels (C60-80Z ^{AC})	X				Check Condition	Replace as Necessary
	Wheels and Bearings			L		Lube Fitting	Multipurpose Grease (See NOTE 2)
	Axle Bolts (Food Processing)			L		Lube	Antiseize Lubricant
4	Casters and Load Wheels (C60-80Z ^{AC})	X				Check Condition	Repair as Necessary
	Caster Adjustment			X		Check Adjustment Gap	Adjust With Shims as Necessary
	Caster Swivel – STD	L	L			Lube Fitting (See NOTE 7)	Multipurpose Grease (See NOTE 2)
	Caster Wheel – HD	L	L			Lube Fitting (See NOTE 7)	Multipurpose Grease (See NOTE 2)

X=Check C=Change L=Lubricate

Table 1. Maintenance Schedule (Continued)

Item No.	Item	1 day/ 8 hr	6 wk/ 250 hr	3 mo/ 500 hr	1 yr/ 2000 hr	Procedure or Quantity	Specification
5	Lift and Lower Linkage (C60-80Z ^{AC})	X				Check Operation	Repair as Necessary
	Load Roller Linkage			L		Lube Fittings	Multipurpose Grease (See NOTE 2)
	Forks to Drive End Frame Linkage			L		Lube Fittings	Multipurpose Grease (See NOTE 2)
6	Coupler (T5-7Z ^{AC})	X				Check Operation	
			L			Lubricate	SAE 20 or 30 Engine Oil
7	Steering	X				Check Operation	Repair as Necessary
	Tilt Pivot and Pin			L		Lubricate	SAE 20 or 30 Engine Oil
	Steer Bearings	X				Check Operation	Repair as Necessary
8	Control Handle and Horn	X				Check Operation	Repair as Necessary
9	BDI, Horn, Key Switch, and Electrical Circuits	X				Check Operation	Repair as Necessary
10	High Speed Switch	X				Check Operation	Repair as Necessary
X=Check C=Change L=Lubricate							

Table 1. Maintenance Schedule (Continued)

Item No.	Item	1 day/ 8 hr	6 wk/ 250 hr	3 mo/ 500 hr	1 yr/ 2000 hr	Procedure or Quantity	Specification
11	Hydraulic System (C60-80Z ^{AC})	X				Check for Leaks	Repair as Necessary
	Hydraulic Hoses and Fittings	X				Visually Inspect for Leaks	Repair as Necessary
				X		Check for Hose Damage and Loose Fittings	Repair or Replace as Necessary
	Hydraulic Oil			X		Check Level (Full Mark on Tank)	Hydraulic Oil (See NOTE 3)
					C	Change (See NOTE 5)	
Hydraulic Oil Strainer				X/C	Inspect / Replace as Necessary	See Parts Manual	
12	Parking Brake	X				Check Operation	Repair as Necessary
					X	Hold on Grade Test (With Capacity Load)	5% Grade (T5-7Z ^{AC}) 10% Grade (C60-80Z ^{AC})
13	Drive Wheel and Tire	X				Check Condition	Repair as Necessary
	Tire	X				Inspect for Damage	Smooth Edges/ Remove Embedded Objects
	Axle Seal	X				Inspect for Oil Leaks	Remove Wrapped Debris
	Wheel Bolts Lug Nuts			X		Tighten as Required (See NOTE 4)	200 ±9 N•m (148 ±7 lbf ft)
14	Master Drive Unit	X				Check Operation	Repair as Necessary
	MDU Gearcase			X		Check Operation	Repair as Necessary
	Oil			X		Check Level	Gear Oil (See NOTE 5 and NOTE 6)
	(T5Z ^{AC} and C60Z ^{AC})				C	1.7 liter (1.8 qt)	
	(T7Z ^{AC} and C80Z ^{AC})					2.0 liter (2.1 qt)	
X=Check C=Change L=Lubricate							

Table 1. Maintenance Schedule (Continued)

Item No.	Item	1 day/ 8 hr	6 wk/ 250 hr	3 mo/ 500 hr	1 yr/ 2000 hr	Procedure or Quantity	Specification
NOTE 1: Equalization charge approximately each month, but not more than each week.							
NOTE 2: Use Mobilgrease® 28 synthetic extra-protection grease (clay) for standard, freezer, and cold storage configurations. Use Amsoil® GHD synthetic multipurpose grease (lithium complex) with 2 to 4% molybdenum disulfide for arctic and food processing configurations and for standard steer bearings on all configurations.							
NOTE 3: Use ISO VG 46 (conventional) antiwear (HCE-140) for standard, freezer, and cold storage configurations. Use Exxon Univis® HVI 26 (synthetic) for arctic and food processing configurations.							
NOTE 4: Apply antiseize at installation and check every 2 to 5 hours until nuts/bolts stay tight for an entire 8-hour shift. Check tightness every 3 months or 500 hours thereafter.							
NOTE 5: Replace after the first 500 hours of service and every 2000 hours or yearly thereafter.							
NOTE 6: Use conventional 80W-90 (GL-5) for standard, freezer, and cold storage configurations. Use synthetic 75W-90 (GL-5) for arctic and food processing configurations.							
NOTE 7: Lubricate every 8 hours if using in a food processing or corrosive environment.							
X=Check C=Change L=Lubricate							

Maintenance Procedures Every 8 Hours or Daily

CHECKS WITH THE KEY SWITCH OFF

NOTE: Be certain to read and understand the information covered in the Introduction section before performing any of the **Maintenance Procedures** that follow.

WARNING

The capacitor in the transistor controller can hold an electrical charge after the battery is disconnected. To prevent electrical shock and injury, discharge the capacitor before inspecting or repairing any component in the drive unit compartment. Wear safety glasses. Make certain the battery has been disconnected.

Put the lift truck on a level surface. Lower the forks and turn the key switch to the **OFF** position. Disconnect the battery. Open the MDU compartment cover. Discharge the capacitor. Check for leaks and conditions that are not normal. Clean any oil or other

spills. Make sure that lint, dust, paper, and other materials are removed from the compartments.

Safety Labels

WARNING

If labels that have warnings or instructions are damaged, they must be replaced immediately.

Check that all safety labels are installed in the correct locations on the lift truck. Make sure that all labels are not damaged and that they can be read. If necessary, see the **Parts Manual** for your lift truck for the correct location of the labels.

Safety labels are installed on the lift truck to give information about possible hazards. It is important that all safety labels are installed on the lift truck and can be read. See the **Parts Manual** for label placement for your lift truck.

Battery

WARNING

DO NOT lay tools on top of the battery.

The acid in the electrolyte can cause injury. If the electrolyte is spilled, make the acid neutral with a solution of sodium bicarbonate (soda) and water, then flush the area with water. Acid in the eyes must be immediately flushed with water continuously for 15 minutes, then seek medical attention.

Batteries generate explosive fumes. Keep the vents in the caps clean. Keep sparks or open flames away from the battery area. DO NOT make a spark from the battery connections. Disconnect the battery when performing maintenance.

The battery must fit the battery compartment so the battery restraint panels will operate correctly. Use spacers to prevent the battery from moving more than 13.0 mm (0.5 in.) in any direction.

NOTE: Battery water levels can be maintained without removing the battery from the truck.

Check for loose or broken electrical connections and damaged wires or cables. Examine the battery case for damage and leakage. See the battery dealer in the area to repair any damage to the battery or cables.

Check that the vent caps are clear. Check the level of the electrolyte daily on a minimum of one cell. Add only distilled water, as necessary, if the cell is low. If one cell is low, check the rest of the cells. The correct level is halfway between the top of the plates and the bottom of the fill hole. Use a hydrometer to check that the battery is not discharged below the minimum specific gravity given by the manufacturer and has enough charge to complete a work period. See How to Charge Battery in this section.

Remove the battery as described in the section **Industrial Battery** 2240 SRM 1. Check the battery case, connector, and cables for damage, cracks, or

breaks. See the battery dealer in your area to repair any damage. Keep the battery case and the battery compartment clean and painted. Leaks and corrosion from the battery can cause a malfunction in the electric controls of the lift truck. Use a water and soda solution to clean the battery and the battery compartment. Keep the top of the battery clean, dry, and free of corrosion.

Make sure the battery is the correct weight and voltage size. Prevent side-to-side movement of the battery by adjusting the brackets on either side of the battery. The correct battery is specified in How to Change Battery and in the **Operating Manual**. The **Operating Manual** is located in the container on the Drive Unit cover. This is a permanent reference and must be available for use at all times.

Frame

WARNING

Forklift truck frames and components may have polyurethane paint. Welding, burning, or other heat sufficient to cause thermal decomposition of the paint may release isocyanates. These chemicals are allergic sensitizers to the skin and respiratory tract and overexposure may occur without odor warning. Always utilize good industrial hygiene practices, including removal of all paint (prime and finish coats) to the metal around the area to be welded. Use local ventilation and/or supplied-air respiratory protection when repairing the frame.

CAUTION

All welding repairs must be pre-approved by Hyster™ company Contact Management.

Check the frame for damage. Inspect for rust and cracks especially near welds. All surfaces of the frame should be covered with paint to prevent rust and corrosion. Heat can weaken metal, preventing some areas of the frame from being repaired. See Welding Repairs.

Drive Tire, Casters (Optional), and Trail Wheels or Load Wheels

CAUTION

If the drive tire has been removed and installed, check all wheel bolts after 2 to 5 hours of operation. Tighten the bolts in a cross pattern (see Drive Tire and Wheel) to the correct torque value shown in the Maintenance Schedule. When the bolts stay tight after eight hours, the interval for checking the torque can be extended to 500 hours.

Inspect the drive tire, casters (optional), and trail wheels or load wheels for damage. Inspect the tread and remove any objects that will cause damage. See Figure 5. Inspect the wheels and casters for loose or missing parts. Remove any wire, strapping, or other material wound around the axles or casters.

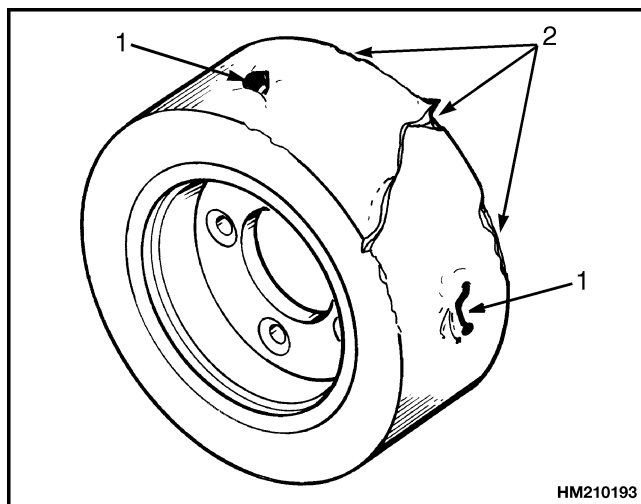

1. OBJECTS EMBEDDED IN TIRE.
2. GROOVES, CUTS, OR OTHER DAMAGE TO TIRE.

Figure 5. Tire and Wheel Inspection

Lift Linkage (C60-80Z^{AC})

A series of levers and rods compose the lift linkage. These devices are connected together and to the frame and lift cylinder in series. The lift cylinder applies force in only one direction. The lift linkage transfers that force to the load wheel linkage and the drive end frame linkage, lifting the truck and load evenly and smoothly. Many pivot points indirectly shoulder the weight of the truck and load. These points must be lubricated every 500 hours/3

months to ensure minimal resistance from friction and damage from heat.

Coupler (T5-7Z^{AC})

The coupler is mounted to the rear of the truck and can be released from the truck using a hand lever. The design of the coupler allows hand-free connections by backing the truck up to the connecting load until the coupler latches. Check that the hand lever moves easily with little resistance and returns to the latched position when released. A simple drop pin-type connector option is also available.

Steering Operation

Check that the steering operates smoothly and gives good steering control. Move the handle to the left or right to steer the lift truck in the desired direction of travel. Reposition the steering control handle up and down to ensure easy adjustment during use.

CHECKS WITH THE KEY SWITCH ON

Control Handle

WARNING

Make sure the area around the lift truck is clear before moving the lift truck or checking for correct operation. Be careful when making the checks.

Check that the speed/direction control and the foot switch for high speed operates as described in the **Operating Manual**. Also check that the horn switch is operational.

The speed/direction control is for selecting forward or reverse movement and the travel speed of the lift truck. The control is spring loaded and should return to the neutral position when the control is released. The control can be operated by either hand. The operator controls the speed and direction of travel by rotating the control in the desired direction. Maximum rotation of the control causes maximum travel speed. To stop or change direction, the operator rotates the control in the opposite direction. The lift truck will come to a stop. If the speed/direction control is not released when the lift truck stops, it will accelerate in the opposite direction. Changing the direction with the speed/direction control is called plugging. Arrows on the control indicate the direction of travel.

Check the operation of the horn. The key switch must be in the **ON** position for the horn to operate.

Gauges

NOTE: The electrical controls will not operate until the key switch is turned to the **ON** position.

Check that all the instruments and controls operate as described in the **Operating Manual**. The **Operating Manual** is located in the container on the MDU cover. This is a permanent reference and must be available for use at all times.

Check the operation of the gauges. The key switch must be in the **ON** position for the gauges to operate. The battery discharge indicator/hourmeter displays the total operation hours. Periodic maintenance recommendations are based on these operating hours.

Fuses

WARNING

The capacitor in the transistor controller can hold an electrical charge after the battery is disconnected. To prevent electrical shock and injury, discharge the capacitor before inspecting or repairing any component in the drive unit compartment. Refer to Special Precautions. Wear the proper protective eyewear. Make certain the battery has been disconnected.

A control fuse is located in-line on the harness and a power fuse is located on the controller. Remove the MDU compartment cover to check the fuses. Check that the fuses are the correct ampere size and are not burned. Some types of fuses must be checked with an ohmmeter. Replace a bad fuse with a fuse with the correct rating. **NEVER** use a fuse with a higher rating. The power and the control fuses have the following ratings:

Control Fuse	Traction Power Fuse
5 Amps	400 Amps

High Speed Switch

The high speed switch is a foot switch located in the floor of the driver's compartment. The high speed function activates when:

- The key switch is in the **ON** position.
- The parking brake switch is in the **OFF** position.
- The directional controls of the control handle are rotated.
- The battery discharge indicator/hourmeter (BDI) reads 20% or greater.

- The high speed switch is depressed.

Test for proper operation of the high speed switch daily to ensure the truck is performing at optimal efficiency.

Hydraulic (C60-80Z^{AC})

WARNING

Always wear the proper protective equipment including eye protection and petroleum-resistant gloves when handling hydraulic oil. Thoroughly wash oil from exposed areas of skin as soon as possible.

Completely lower forks to relieve hydraulic pressure before disassembling any part of the lift pump or disconnecting any hydraulic hoses.

The hydraulic oil is hot at normal operating temperatures. Be careful when draining the oil.

Never check for leaks by putting hands on hydraulic lines or components under pressure. Hydraulic oil under pressure can be injected into the skin.

CAUTION

Protect the hydraulic system from dirt and contaminants when servicing the hydraulic system.

Never operate the pump without the proper amount of oil in the hydraulic system. The operation of the hydraulic pump with low oil levels will damage the pump.

Inspect the hydraulic system for leaks and damaged or loose components.

Inspect all hydraulic hoses and fittings for leaks. Check for broken or defective clamping devices. Repair or replace any damaged components as necessary.

The hydraulic oil level must be checked daily. Operating a truck without enough hydraulic oil can cause substandard performance and can damage the hydraulic system. Fill the reservoir to the **MIN** mark with hydraulic oil.

Hand Brake



WARNING

DO NOT operate a truck with an improperly functioning brake.

A two-stage hand brake is mounted just below the control handle and connects to the control handle wiring harness. The hand brake assembly consists of two independent handles, various linkages, and three switches to perform two different braking functions. Check for proper operation of the brake. When either hand brake handle is placed in the first position, the controller places the traction motor into

re-gen mode. This slows the truck by using opposing magnetic fields inside the traction motor. A spring-applied/electrically released brake is mounted to the top of the traction motor. When the key switch is in the **ON** position and the parking brake is in the **OFF** position, the coil pulls the pressure plate away from the friction disc disengaging the brake. The brake is applied when the brake handle is placed in the second position, the parking brake switch is in the **ON** position, or when the key switch is in the **OFF** position.

Maintenance Procedures Every 250 Hours or Every 6 Weeks

CASTER LUBRICATION



CAUTION

Use only the recommended lubricants for your application. Refer to Capacities and Specifications 8000 SRM 1033 for lubrication specifications for your lift truck.

Wipe grease fittings clean before greasing.

NOTE: Some optional packages may utilize sealed bearings or different grease fitting configurations. Contact your Hyster™ dealer for information on optional packages.

The casters should be lubricated every 250 hours or 6 weeks during normal operation. The standard caster has one grease fitting above the springs which provides lubrication to the swivel bearing. See Figure 6.

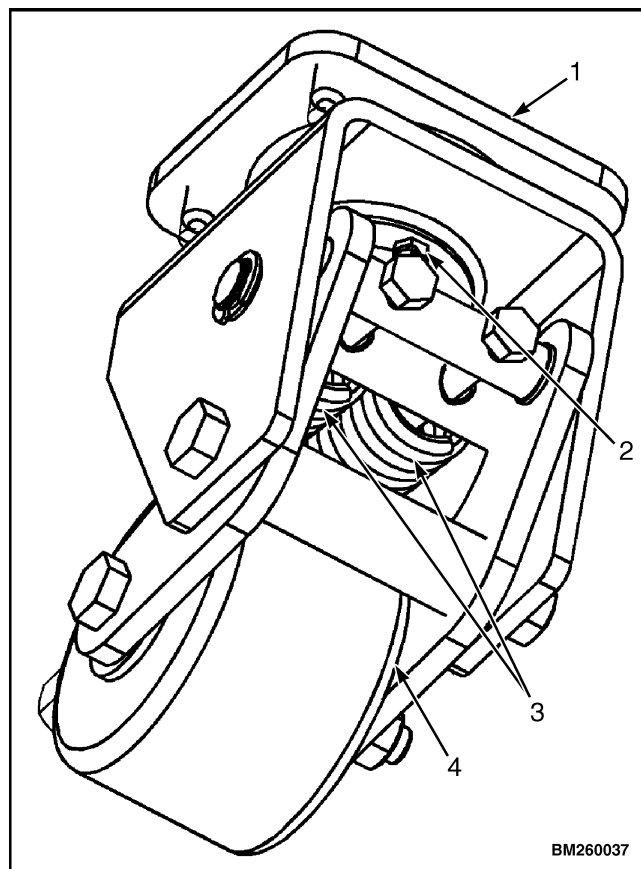

1. SWIVEL MOUNT
2. GREASE FITTING
3. SPRINGS
4. CASTER WHEEL

Figure 6. Standard Caster